

LEGEND:

- EXISTING BOUNDARY
- EXISTING SWM AREA
- EXISTING SANITARY SEWER
- EXISTING CLEAN OUT
- EXISTING STORM SEWER
- EXISTING WATERLINE
- EXISTING FIRE HYDRANT
- EXISTING WATER VALVE
- EXISTING UTILITY POLE
- EXISTING UNDERGROUND ELECTRIC
- EXISTING GAS LINE
- EXISTING GAS VALVE
- EXISTING CURBLINE
- PROPOSED CURBLINE
- EXISTING SIDEWALK
- PROPOSED SIDEWALK
- PROPOSED CROSSWALK

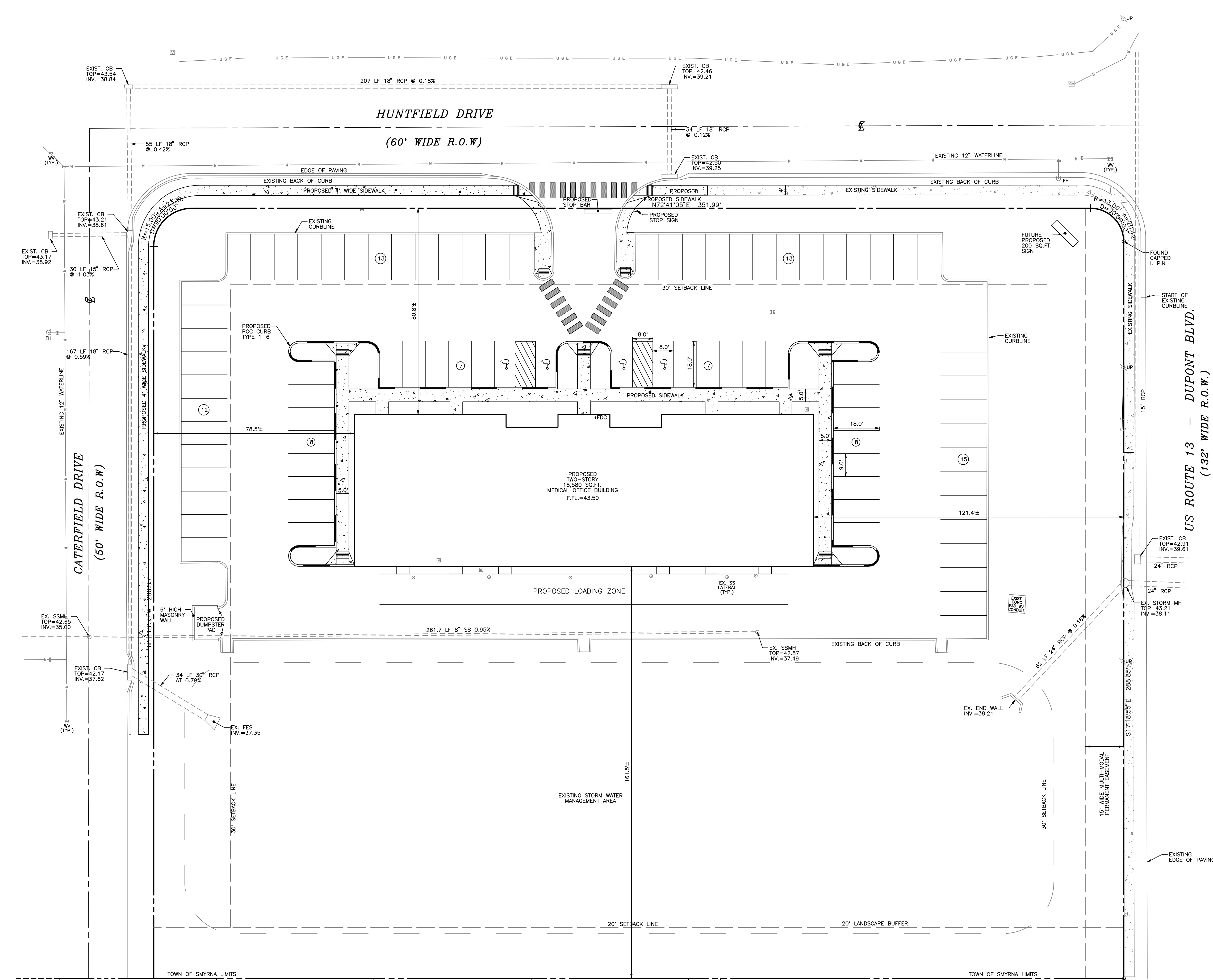
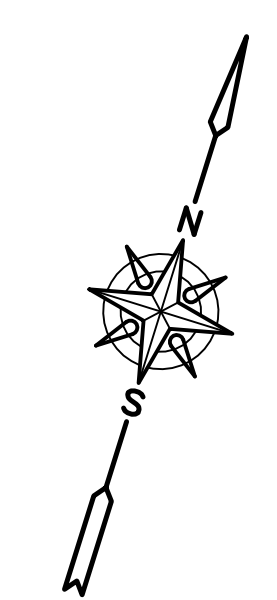

SITE PLAN
FOR LANDS OF
HUNTFIELD COMMERCIAL
MAJOR SITE PLAN
PREPARED FOR
BLACKSTONE BUILDING GROUP, LLC.
DUCK CREEK HUNDRED
KENT COUNTY DELAWARE

Revision	Date
1.) REVISED PER COMMENTS	03/25/2020
2.) REVISED PER TOWN OF SMYRNA	06/18/2020

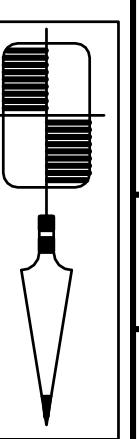

Clifton L. Bakhsh, Jr., Inc.
Land Surveyors & Planners
4450 Summit Bridge Road, Middletown, DE 19709 (302) 378-8009

Date : January 7, 2020 Drawn By : F.R.Perno
Scale : 1" = 20' Checked By :
Job No. : MJ - 23095

GRAPHIC SCALE 1" = 20'
20' 10' 0 20' 40'

Sheet No. 2 of 4

LANDS N.O.F. OF ANNA RISH T.P. #1-00-02800-01-1600-00001 D.R. #6593-0281 ZONE: AC
 LANDS N.O.F. OF KENNETH ABBOTT T.P. #1-00-02800-01-1600-00001 D.R. #6593-0281 ZONE: AC
 LANDS N.O.F. OF LESTER BRADLEY T.P. #1-00-02800-01-1700-00001 D.R. #0591 0028 ZONE: AC
 LANDS N.O.F. OF LESTER BRADLEY T.P. #1-00-02800-01-1700-00001 D.R. #0591 0028 ZONE: AC
 LANDS N.O.F. OF KENNETH ABBOTT T.P. #1-00-02800-01-1800-00001 D.R. #6593-0281 ZONE: AC